

MLJPS - (Codigo raiz)



Potência	Tensão	Fluxo Luminoso (CW)	Dimensões (mm)	Peso (Kg)
20W	100~260Vca	2580	A = 895	1,9
30W		3870	A = 895	1,9
40W		5160	A = 895	1,9
50W		6450	A = 1725	3,7
60W		7740	A = 1725	3,7
70W		9030	A = 1725	3,7
80W		10320	A = 1725	3,7

*Fluxo luminoso NW e WW solicitar.

MARCAÇÃO	
Grau de Proteção	IP65

Sobressalentes	
Código	Item
Borracha	MLJPS0010
CJ Difusor Polic. Transp	MLJPSCI001S
CJ Difusor Polic. Leitoso	MLJP0012
Drive	Ver catálogo

Descrição do produto

Luminária LED estanque.

- Corpo:** Alumínio;
- Difusor:** Policarbonato transparente, policarbonato translúcido (leitoso);
- Fator de potência:** >0,95;
- Frequência:** 50/60Hz;
- Entrada:** Por prensa cabo;
- Suporte:** Incluso;
- Nota:** Outras tensões sob consulta.

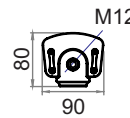
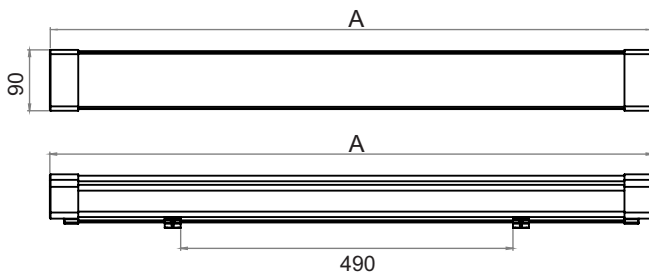
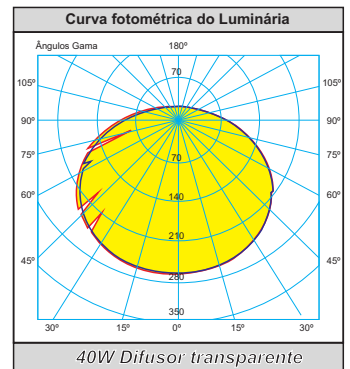
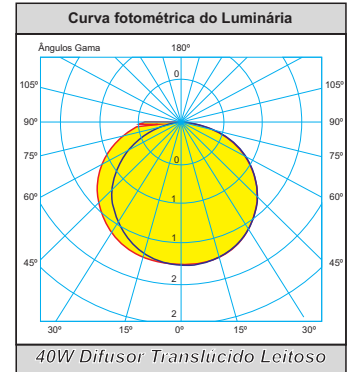

Suporte de teto (Padrão)

Suporte de teto

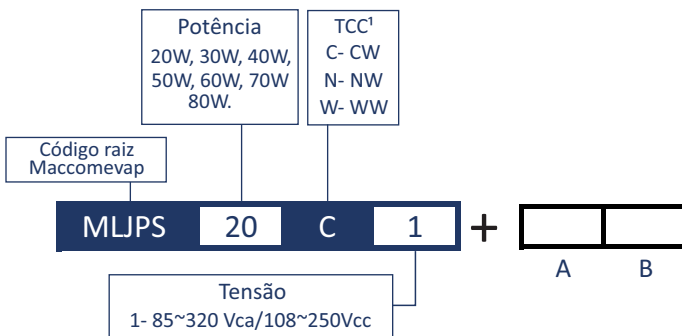
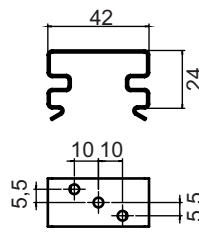
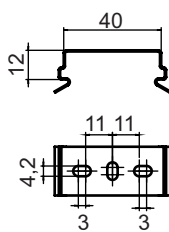

1 - TCC - Temperatura de cor correlata

PRENSA CABOS E/OU TAMPÕES			ALUMÍNIO	LATÃO NIQUELADO	AÇO INOX	POLIAMIDA	
MODELO	ROSCA	RANGE					
PRENSA CABO A2F 148	M16	3,5-11,5	01A	01L	01I	N/A	
	M20P	8,0-16,0	02A	02L	02I		
	M20G	8,0-16,0	03A	03L	03I		
PRENSA CABO E1F 147	M16	3,5 - 8,5 / 8,4 - 13,2	06A	06L	06I		
	M20P	8,0 - 11,5 / 12,9 - 15,8	07A	07L	07I		
	M20G	11,0 - 13,5 / 15,5 - 20,8	08A	08L	08I		
PRENSA CABO E1F 160	M20P	6,0 - 12,0 / 9,5 - 16,0	10A	10L	10I		
	M20G	8,0 - 14,0 / 12,5 - 21,0	11A	11L	11I		
PRENSA CABO A2 159	M16	7,5 - 10,0	N/A				14P
	M20P	6,0 - 12,0					15P
	M20	10,0 - 14,0				16P	
TAMPÃO 158	M16	N/A	19A	19L	19I	19P	
	M20	N/A	20A	20L	20I	20P	