

GHBL
(Luminária)
(Light Fixture)



GHBP
(Projeto)(Floodlight)



APROVAÇÕES



Exd

Marcação / Ex mark	
Gases	Ex db op is IIC T* Gb
Pó / Dusty	Ex tb IIIC T* Db
Classes de temperatura / Temperature class	
Gases	T*
Pó / Dusty	T* °C
Grau de proteção / Degree protection	
IP66	
Zonas / Zones	
1, 2, 21 e 22;	
Temperatura de operação / Operating temperature	
-20°C ≤ Ta ≤ + 50°C	
Vida útil / Life time	
> 50.000h	
LED	

Aplicação / Application

Utilização em áreas classificadas com atmosferas explosivas como: plataformas offshore, onshore, refinarias, indústrias petroquímicas, químicas, alimentícias, farmacêuticas, módulos de abastecimento, unidades de acetileno, hidrogênio, tintas, vernizes, depósitos de inflamáveis e etc.

Suitable for use in hazardous areas like: offshore platforms, refineries, petrochemical, chemical, pharmaceutical and food industries, supply modules, containers of acetylene, hydrogen, paints and varnishes, storage of flammables and others.

Descrição do produto

Luminária LED / Projeto LED, à prova de explosão com compartimento do driver incorporado.

- Corpo:** Alumínio;
- Acabamento:** Pintura a pó eletrostática (Cinza; Outras sob consulta)
- Difusor:** Vidro temperado;
- Entrada:** Por prensa cabo;
- Fator de potência:** >0,95;
- Peso:** 3,5Kg;
- Normas técnicas:** ABNT NBR IEC 60079-0/1/31, ABNT NBR IEC 60529;
- Nota:** Outras potências e/ou tensões sob consulta. / Opção de sistema antequeda.

Product description

Light fixture LED / Floodlight LED, explosion-proof with built-in driver compartment.

- Body:** Aluminum;
- Finishing:** Painted with electrostatic powder (Gray; Others on request);
- Diffuser:** Tempered glass;
- Entry:** For cable gland;
- Power factor:** >0,95;
- Weight:** 3,5Kg;
- Technical standards:** ABNT NBR IEC 60079-0/1/31, ABNT NBR IEC 60529;
- Note:** Other power and/or voltages on request. Option drop-safe system.

Potência (W) Power (W)		30	45	60
Classes de temperatura Temperature class	+40°C +50°C	T5/T100°C T4/T125°C	T5/T100°C T4/T125°C	T5/T100°C T4/T125°C
Luminária / Projeto Light fixture / Floodlight				
Tensão Voltage	TCC CCT	100~277Vca / 12~24Vcc		
		100~305Vca / 142~431Vcc		
Luminária \ Light fixture	CW 136 lm/W	4.080	6.120	8.160
Eficiência \ Potência	NW 130 lm/W	3.900	5.850	7.800
Efficiency \ Power	WW 124 lm/W	3.720	5.580	7.440

TCC = Temperatura de cor correlacionada
CCT = Correlated colour temperature

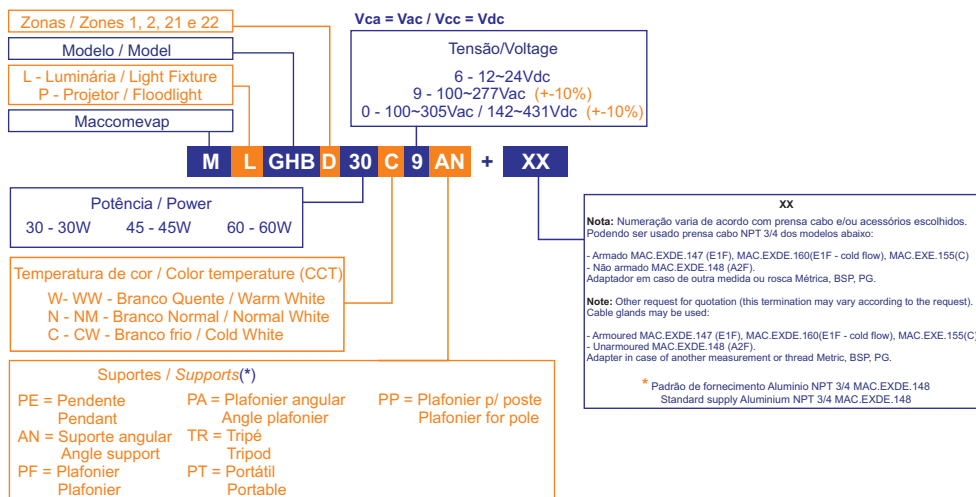

(*)Nota: Suporte: Outras opções verificar página de suportes roscados
Note: Support: Other options check page of threaded brackets

GHBL
(Luminária)
(Light Fixture)



GHBP
(Projetor)
(Floodlight)



APROVAÇÕES
✓ LM80
✓ LM79

Exd

Marcação / Ex mark	
Gases	Ex db op is IIC T* Gb
Pó / Dusty	Ex tb IIIC T* Db
Classes de temperatura / Temperature class	
Gases	T*
Pó / Dusty	T* °C
Grau de proteção / Degree protection	
IP66	
Zonas / Zones	
1, 2, 21 e 22;	
Temperatura de operação / Operating temperature	
-20°C ≤ Ta ≤ +50°C	
Vida útil / Life time	
> 50.000h	
LED	

DESENHO DIMENSIONAL / DIMENSION DRAWING (mm)

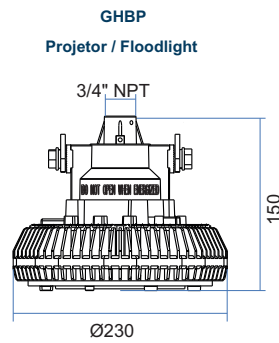
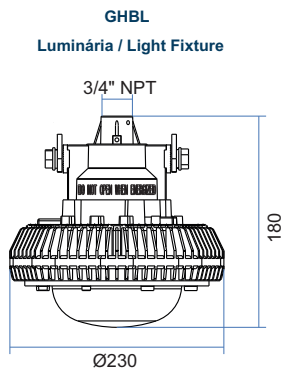

PT - Portátil / Portable

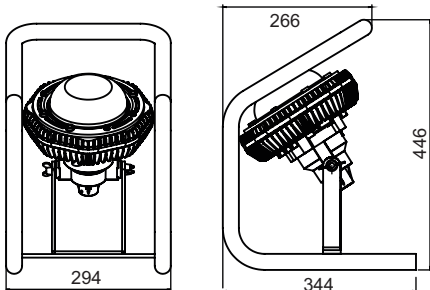

PF - Plafonier / Plafonier

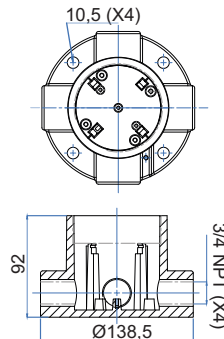

**PA - Plafonier angular
Angle plafonier**

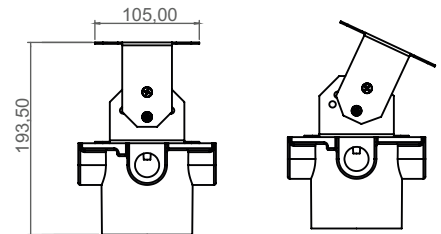

**PP - Plafonier angular p/ poste
Angle plafonier for pole**

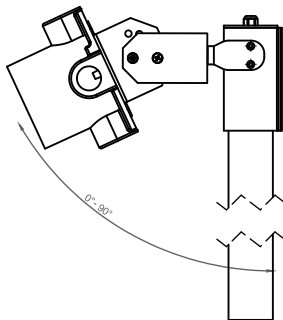

**AN - Suporte angular
Angle support**

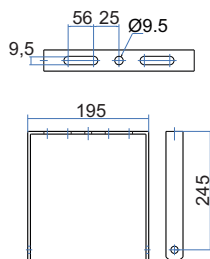

TR - Tripé / Tripod

